

Safety Instructions

>All electrical work must be undertaken by a qualified contractor to ensure compliance with latest edition BS 7671 and IEE/IET wiring regulations.

>Before installing a LED Linear or doing any maintenance, ensure power supply is turned off at the circuit breaker or fuse box.

>This product is designed for permanent connection to fixed wiring; the circuit should be protected with the appropriate MCB or fuse.

Environment

>Please DO NOT dispose of electrical items or packaging as unsorted waste, use the recycling facilities provided by your local authorities.

PRODUCT DIMENSIONS

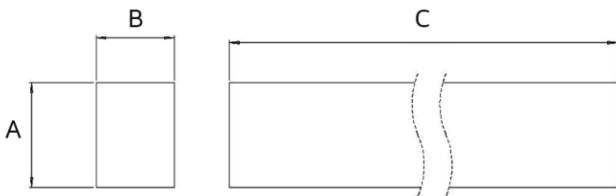

Size (ft)	A	B	C
4	75	56	1204

All units are in mm

Important Warranty Information

The LED Linear has a 3 year warranty, which can be extended free of charge to 5 years by registering online via the website address below. The registrant must provide the product part number and date of manufacture, which can be found on the label attached to the luminaire housing.



Certificate No. FS 571788



Certificate No. EMS 571787

NET LED Limited
Buckingway Business Park
300 Anderson Road
Cambridge
CB24 4UQ UK
sales@netled.co.uk
www.netled.co.uk

Technical Helpline: 01223 851505
Email: support@netled.co.uk

www.netled.co.uk/downloads

Distributed by



LED BATTEN INSTALLATION GUIDE

LED BATTEN NET-43-11-48

KEY DATA	
Light Source:	LED 
Length	4ft
Length	1200mm
Power	36W
Luminous Flux(3000K)	3950lm
Luminous Flux(4000K)	5200lm
Luminous Flux(5000K)	4750lm
Luminous Efficacy	105lm/W
Colour Temperature	3000/4000/5700K
Colour Rendering	>80 CRI
Housing Material	Aluminium
Diffuser Material	Polycarbonate
IP Rating	IP40
Manufacturer	Sochii Lighting

SUPPLY/EARTH CLASS

220-240V AC 50/60 Hz



Class I

Fig.1 Mains Input Termination

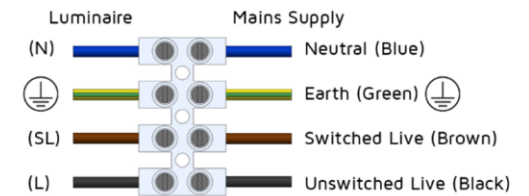

Installation procedure: Carefully read the installation instructions and ensure the mains supply is isolated before installation. Please read the safety information overleaf before carrying out any installation. Please retain the leaflet for future reference.

Installation Instructions



Non-replaceable light source



Replaceable control gear by professional

Recess mounting:

Step 1: Ensure all recess mounting kit components are included.

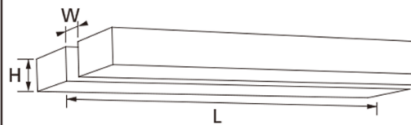
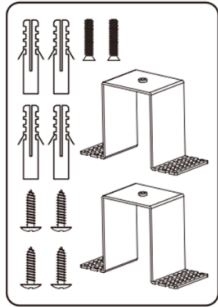

Spec	(L)Length	(W)Width	(H)Height
	1200mm	1208mm	65mm
			>80mm

Step 2: Remove Linear from packaging and ensure all components are included. Press the release clip on both sides to separate the securing bracket.

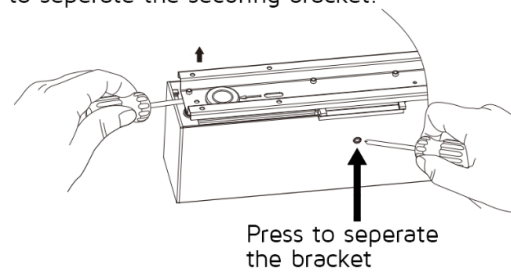

Step 3: Disconnect the LED connector and safely clips to release the Linear from the securing bracket.

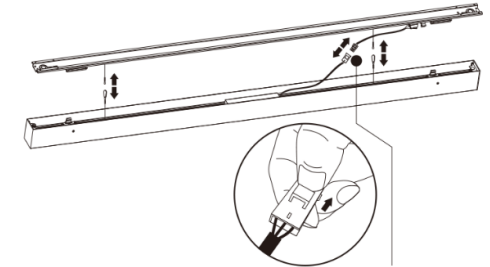

Step 4: Connect the power input cable in accordance to the below wiring diagram.

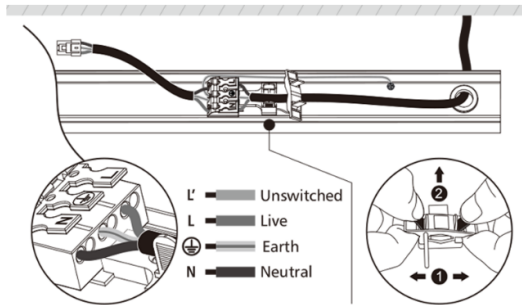

Standard	Emergency	DALI/Dim
<p>L = Live ⊕ = Earth N = Neutral</p>	<p>L' = Unswitched L = Live ⊕ = Earth N = Neutral</p>	<p>DALI+ = DIM+ DALI- = DIM- L = Live ⊕ = Earth N = Neutral</p>

Step 5: Attach the recess mounting brackets to the securing bracket with the fixing screws.

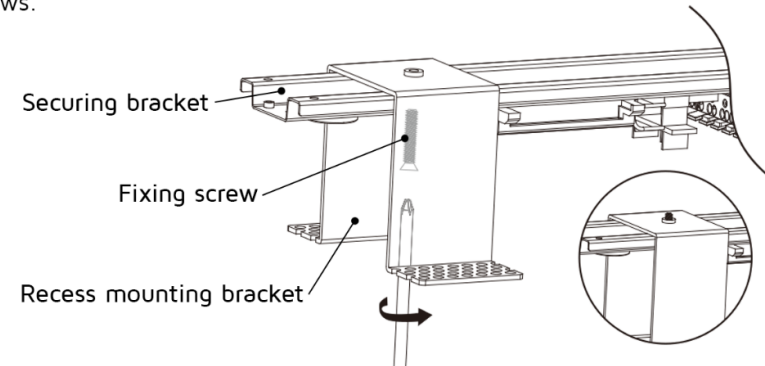

Step 6: Attach the recess mounting brackets to the ceiling tile with the fixing screws included.

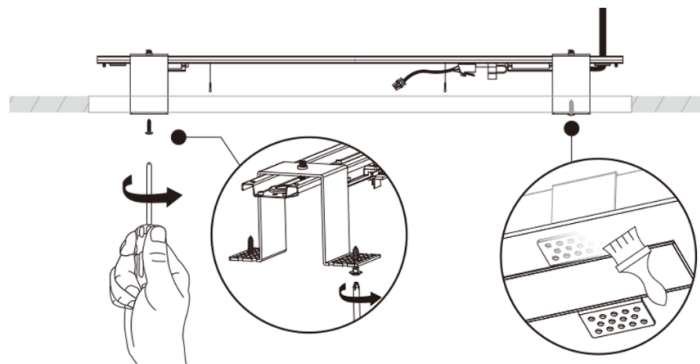

Paint the frame with the same color as the ceiling

Step 7: Re-attach the safety clips and the LED connector. Attach Linear to securing bracket. Listen for the 'click' from the release clips to ensure it has attached correctly.

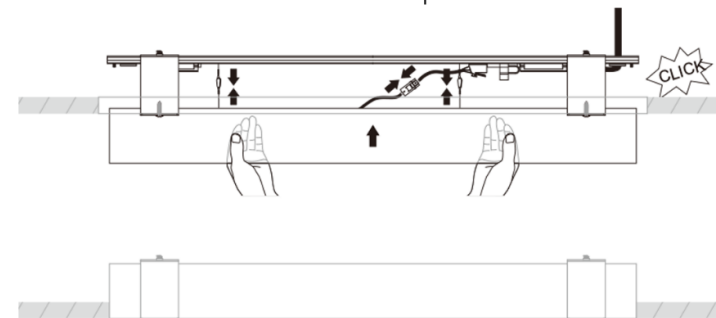

COMPLETE